

From the world leaders in virtual graphics, Synaptics brings you the highly integrated DisplayLink DL-3000 family of “Dock on a Chip” SoCs. Taking advantage of SuperSpeed USB 3.2’s bi-directional throughput, these chips can simultaneously drive up to two Full HD displays, as well as Gigabit Ethernet network data and multi-channel audio. The DL-3000 chips bring new levels of affordability, universal compatibility, ease of use and high performance to USB 3.2 peripherals, while raising the bar for USB 3 graphics performance. The DL-3000 series enables single and dual head docking stations,

USB monitors, bus-powered graphics adapters and USB 3.2 projectors. Combine the benefits of USB monitors and docks into Full HD USB 3.2 monitors with built-in network and multi-channel audio with the DL-3700. For a highly portable, bus-powered dual head 2K docking station network and audio, pair the DL-3900 with a USB hub.

Requiring only a DisplayLink driver on the host computer, the DL-3000 series SoCs are compatible with both USB Standard-A and USB-C interfaces across all major platforms. Partner the DL-3000 Series SoC with DDR3 and I²C EEPROM for a highly integrated solution.

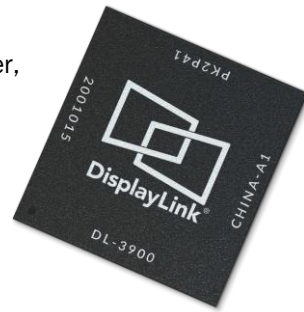

Applications and Benefits

- Single and dual head high-performance docking stations with network, audio and multiple display outputs
 - USB 3 graphics adapters for VGA, DVI, HDMI and DisplayPort* monitor connections
 - Portable bus-powered docking stations**
 - Bus-powered USB 3 monitors with built-in audio and network** USB 3 projectors
 - USB 2.0 and USB 3.2 Gen 1 bus power capable
 - Compatible with DisplayLink PXE boot driver for pre-OS network connectivity
- * DisplayPort output requires an external transmitter.
 ** Bus power capability requires a USB hub.

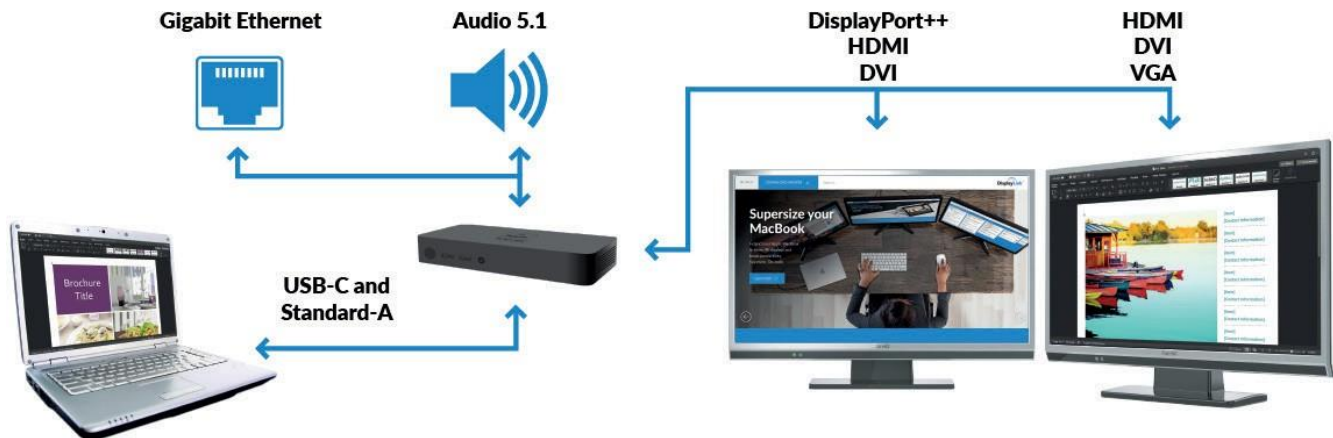

DisplayLink Certified Plug and Display

DisplayLink Certified products are thoroughly tested in our labs to guarantee interoperability with the vast DisplayLink graphics ecosystem. Regular software updates ensure a lifetime of performance enhancements.

Look for the DisplayLink Certified Plug and Display mark.



Product Feature	DL-3100	DL-3500	DL-3700	DL-3900	DL-3950
Dual head output				✓	✓
Maximum resolution	1x 2048x1152 1x 1920x1080	1x 2560x1600 1x 2048x1152 1x 1920x1080	1x 2560x1600 1x 2048x1152 1x 1920x1080	1x 2560x1600 1x 2048x1152 1x 1920x1080	1x 2560x1600 1x 2048x1152 1x 1920x1080
DL3 video-tuned compression	✓	✓	✓	✓	✓
Integrated VGA	✓	✓	✓	✓	✓
Integrated DVI (with HDCP)	✓	✓	✓	✓	✓
Integrated HDMI (with HDCP 1.x)		✓	✓	✓	✓
DisplayPort 1.1 support		✓	✓	✓	✓
USB 3.2 Gen 1 input	✓	✓	✓	✓	✓
USB Standard-A and USB-C input	✓	✓	✓	✓	✓
Gigabit Ethernet MAC			✓	✓	✓
5.1 channel audio		✓	✓	✓	✓
HDCP support (requires DCP license)*	✓	✓	✓	✓	✓
DDR3 and I ² C EEPROM required	✓	✓	✓	✓	✓

* Non-HDCP version available.

Packaging

- 18 mm x 18 mm x 1.2 mm
- 484 BGA, RoHS compliant
- 0.8 mm lead pitch

Reference Designs

Synaptics supplies a full set of schematics and PCB layout information along with firmware and OS drivers to complete a bus-powered or mains-powered monitor design.

Ease of Deployment

DisplayLink drivers are available to deploy via Windows Update and are built into Chrome OS. Drivers are available from the Google Play Store for Android, and from DisplayLink directly for MacOS and Ubuntu.

Trademarks

Synaptics and the Synaptics logo are trademarks or registered trademarks of Synaptics Incorporated or its affiliates in the United States and/or other countries.

All other marks are the property of their respective owners.

Notice

Use of the materials may require a license of intellectual property from a third party or from Synaptics. This document conveys no express or implied licenses to any intellectual property rights belonging to Synaptics or any other party.

Supported Platforms

- Windows[®] 10 /Windows 7
- MacOS
- Android
- Ubuntu
- Chrome OS

